

Connection fittings

Type VA20S

For extraction, exhaust and conveying hoses type FA, FG, FS, SD

Design:

Cylindrical sleeve

Installation type:

Sealed by compression and riveted, soldered or clamped

Materials:

Stainless steel (1.4301)

Operating temperature:

600° C

Order specifications:

Connection fitting type VA20S

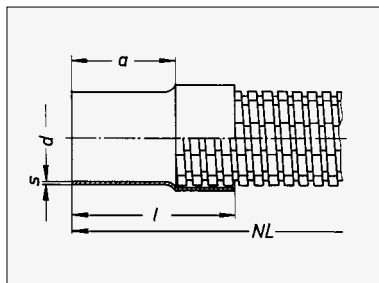

DN	d mm	s mm	a mm	l mm	Weight approx. kg/m
40	40	1.0	45	90	0.09
50	50	1.0	45	90	0.13
60	60	1.0	45	90	0.18
70	70	1.0	45	90	0.22
80	80	1.0	50	105	0.25
100	100	1.0	50	105	0.39
120	120	1.0	60	120	0.46
125	125	1.0	60	120	0.48
150	150	1.25	60	120	0.77
180	180	1.25	80	140	1.03
200	200	1.25	80	140	1.33
250	250	1.25	80	140	1.97
300	300	1.5	80	140	3.18
315	315	1.5	80	140	3.33
350	350	1.5	80	140	3.84

Please quote when ordering:

type of fitting, nominal diameter (DN), installation type. Other sizes available on request.

Connection fittings

Type VB20S

For extraction, exhaust and conveying hoses type FA, FG, FS, SD

Design:

Sleeve with 2 slots, cylindrical

Installation type:

Sealed by compression and riveted, soldered or clamped

Materials:

Stainless steel (1.4301)

Operating temperature:

600° C

Order specifications:

Connection fitting type VB20S

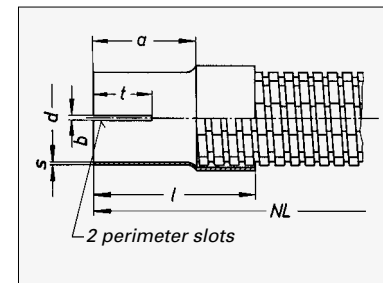

DN	d mm	s mm	b mm	t mm	a mm	l mm	Weight approx. kg/m
40	40	1.0	2	30	45	90	0.09
50	50	1.0	2	30	45	90	0.13
60	60	1.0	2	30	45	90	0.18
70	70	1.0	2	30	45	90	0.22
80	80	1.0	2	35	50	105	0.25
100	100	1.0	3	35	50	105	0.39
120	120	1.0	3	40	60	120	0.46
125	125	1.0	3	40	60	120	0.48
150	150	1.25	3	40	60	120	0.77
180	180	1.25	3	50	80	140	1.03
200	200	1.25	3	50	80	140	1.33
250	250	1.25	3	50	80	140	1.97
300	300	1.5	3	50	80	140	3.18
315	315	1.5	3	50	80	140	3.33
350	350	1.5	3	50	80	140	3.84

Please quote when ordering:

type of fitting, nominal diameter (DN). Other sizes available on request.

Connection fittings

Type VF20S

Sleeve for extraction, exhaust and conveying hoses type FA, FG, FS, SD

Design:

Sleeve with L-slot, cylindrical

Installation type:

Sealed by compression and riveted, soldered or clamped

Materials:

Stainless steel (1.4301)

Operating temperature:

600° C

Order specifications:

Fitting type VF20S

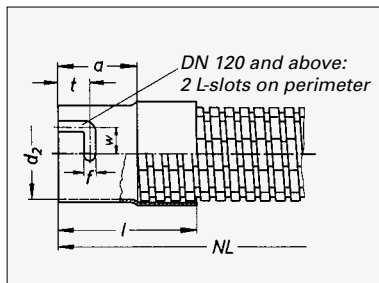

DN	d ₂ mm	f mm	t mm	w mm	a mm	l mm	Weight approx. kg/m
50	52.5	9	20	15	50	95	0.10
60	63	9	20	15	50	95	0.15
70	73	9	20	15	50	95	0.17
80	83	9	20	15	50	105	0.19
100	103	9	25	25	60	115	0.29
120	123	9	25	25	60	120	0.34
125	128	9	25	25	60	120	0.36
140	144	9	30	25	70	130	0.71
150	154	9	30	25	70	130	0.75
180	184	9	30	25	70	130	0.89
200	204	11	40	30	90	150	1.29
250	255	11	40	30	90	150	2.11
300	305	11	40	30	100	160	2.81
315	320	11	40	30	100	160	2.94
350	355	11	45	30	110	170	3.64

Please quote when ordering:

type of fitting, nominal diameter (DN), installation type. Other sizes available on request.

Connection fittings

Type VF20S

Sleeve for extraction, exhaust and conveying hoses type FA, FG, FS, SD

Design:

Sleeve with pin, cylindrical

Installation type:

Sealed by compression and riveted, soldered or clamped

Materials:

Stainless steel (1.4301)

Operating temperature:

600° C

Order specifications:

Fitting type VF20S

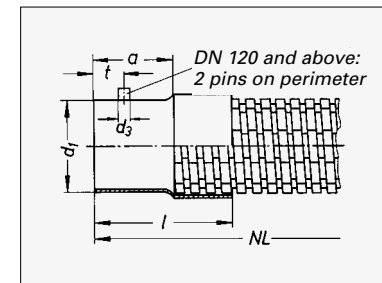

DN	d ₁ mm	d ₃ mm	t mm	a mm	l mm	Weight approx. kg/m
50	52	8	20	50	95	0.11
60	62	8	20	50	95	0.16
70	72	8	20	50	95	0.18
80	82	8	20	50	105	0.20
100	102	8	25	60	115	0.30
120	122	8	25	60	120	0.35
125	127	8	25	60	120	0.37
140	143	8	30	70	130	0.73
150	153	8	30	70	130	0.77
180	183	8	30	70	130	0.91
200	203	10	40	90	150	1.33
250	254	10	40	90	150	2.16
300	304	10	40	100	160	2.87
315	319	10	40	100	160	3.00
350	353	10	45	110	170	3.71

Please quote when ordering:

type of fitting, nominal diameter (DN), installation type. Other sizes available on request.

Connection fittings

Swivel-type flange joint for extraction, exhaust and conveying hoses

Type FA, FG, FS, SD

Design:

Swivel-type flange joint

Installation type:

Sealed by compression and riveted, soldered or clamped

Materials:

• EA20S: Stainless-steel sleeve, stainless-steel-flange (1.4301)

• EA80S: Stainless-steel sleeve (1.4301), flange, galvanised steel

Operating temperature:

• EA20S: 600° C
• EA80S: 480° C

Order specifications:

Fitting type EA20S or EA80S

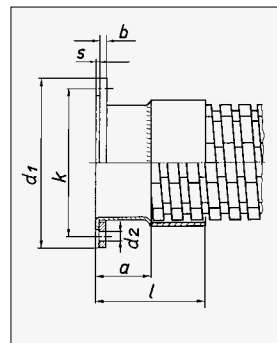

DN	Inside diameter d1	b	k	Number of holes	d2	s	a	l	Weight approx.
	mm	mm	mm	–	mm	mm	mm	mm	kg/m
50	115	6	89	4	9.5	1	40	85	0.48
60	125	6	99	4	9.5	1	40	85	0.55
70*	133	6	110	4	9.5	1	40	85	0.61
80*	142	6	118	4	9.5	1	40	95	0.67
100*	162	6	139	4	9.5	1	50	105	0.87
120*	187	6	165	4	9.5	1	50	110	1.03
125*	187	6	165	4	9.5	1	50	110	1.04
140*	212	6	182	8	11.5	1	60	120	1.34
150*	252	6	219	8	11.5	1.25	60	120	1.83
200*	273	6	241	8	11.5	1.25	60	120	2.10
250*	323	6	292	8	11.5	1.25	60	120	2.58
300	383	8	349	8	11.5	1.5	60	120	4.48
315*	398	8	366	8	11.5	1.5	60	120	4.75
350*	438	8	405	8	11.5	1.5	60	120	5.21
400*	484	8	448	12	11.5	1.5	70	130	6.28
500*	584	8	551	12	11.5	2	70	130	8.86

*Flange dimensions to DIN 241545, 2nd edition July 1990. Other sizes available on request.

Please quote when ordering: type of fitting, nominal diameter (DN), installation type.

Type EA

Connection fittings

Quick-release coupling for extraction, exhaust and conveying hoses

Type FA, FG, FS, SD

Design:

Type WE20S

• Coupling element with guide and clamp lock
• DN 200 and above: comes with 2 wooden handles

Type WK20S

Flange element with guide suitable for coupling element

Installation type:

Sealed by compression and riveted, soldered or clamped

Materials:

Stainless steel

Operating temperature:

600° C
Order specifications:
Fitting type VF20S

Available accessories:

• Screen, galvanised steel
• Lid with chain, galvanised steel
• Handles, 1 pair, wood

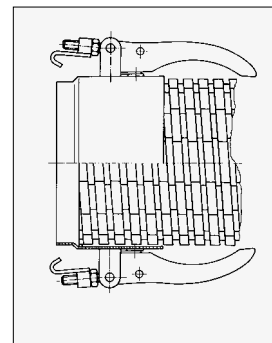

DN	Clamp lock	Wooden handles
100	2 units	–
125	2 units	–
150	2 units	–
200	3 units	2 units
250	3 units	2 units
300	3 units	2 units
315	3 units	2 units

Please quote when ordering: fitting type, nominal diameter (DN), installation type.

Other sizes available on request.

